

8700

Skiving cutter for internal and external gears

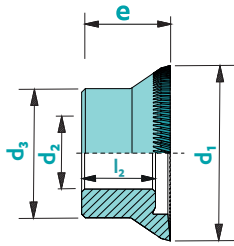

Material	Vc uncoated	Vc coated	Uncoated	Coated	Rec. Coating
Steel 20AP	70	90	■	□	TRIO (PO)
Steel Law 100X	70	90	■	□	TRIO (PO)
Carbon steel (Finemac)	50	60	■	■	TRIO (PO)
4C27A	60	70	■	■	TRIO (PO)
CK45	80	90	■	■	TRIO (PO)
316L	60	70	■	■	TRIO (PO)
Other stainless steel	60	70	■	■	TRIO (PO)
Leaded brass	150	170	■	-	SOLO (DA)
Lead-free brass	150	170	■	□	SOLO (DA)
CuBe (copper alloys)	100	120	■	□	SOLO (DA)
Nickel silver (Maillechort)	120	140	■	□	SOLO (DA)
Bronze	120	140	■	□	SOLO (DA)
Aluminium	200	220	■	-	SOLO (DA)
Titanium	80	90	■	-	-

not adapted - adapted □ highly adapted ■

Tolerances d_2 : H3 e : ± 0.01

Circular

Standard modules: 0.050 - 1.000. Other modules upon request

d_1	e	d_2	d_3	l_2
20-25	12	10	18	10
25-32	12	10	18	10

Other dimensions available upon request.

Z: according to machined part

On a shank

Standard modules: 0.050 - 1.000. Other modules upon request

d_1	e	D	L
2-4	0.5-1.0	4	38
3-6	1.0-2.0	6	51
6-8	2.0-3.0	8	61
8-12	3.0	10	61
12-20	3.0-4.0	10	61

Other dimensions available upon request.

d_2 et l_2 : according to machined part

Available uncoated or coated

Topping

CARB

$m \geq 0.050$

Option : No topping

