

Hobs for frontal gear cutting

Material	Vc uncoated	Vc coated	Uncoated	Coated	Rec. Coating*
Steel 20AP	70	90	■	□	TRIO (PO)
Steel Law 100X	70	90	■	□	TRIO (PO)
Carbon steel (Finemac)	50	60	■	■	TRIO (PO)
4C27A	60	70	■	■	TRIO (PO)
CK45	80	90	■	■	TRIO (PO)
316L	60	70	■	■	TRIO (PO)
Other stainless steel	60	70	■	■	TRIO (PO)
Leaded brass	150	170	■	-	SOLO (DA)
Lead-free brass	150	170	■	□	SOLO (DA)
CuBe (copper alloys)	100	120	■	□	SOLO (DA)
Nickel silver (Maillechort)	120	140	■	□	SOLO (DA)
Bronze	120	140	■	□	SOLO (DA)
Aluminium	200	220	■	-	SOLO (DA)
Titanium	80	90	■	-	-

Tolerances d_1 : H3 e : +0/-0.01

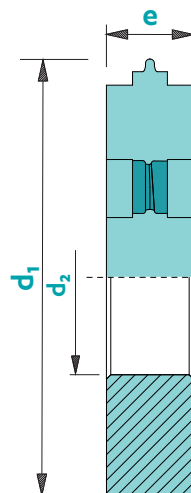

Standard modules: 0.030 - 0.500. Other modules upon request

d_1	e	d_2	Z
6	2	3.5	2-5
8	2	3.5	2-5
10	2	3.5	2-5
10	2	4.5	2-5
12	2	4.5	2-5
12	2	5.0	2-5
12	2	6.0	2-5
16	2	8.0	2-5
18	2	6.0	2-5
18	2	8.0	2-5
24	2	8.0	2-5

Available uncoated or coated



Z2-5

λ
0°

γ
0°

CARB