

Tooth by tooth gear cutter

Material	Vc uncoated	Vc coated	Uncoated	Coated	Rec. Coating*
Steel 20AP	70	90	■	■	TRIO (PO)
Steel Law 100X	70	90	■	■	TRIO (PO)
Carbon steel (Finemac)	50	60	■	■	TRIO (PO)
4C27A	60	70	■	■	TRIO (PO)
CK45	80	90	■	■	TRIO (PO)
316L	60	70	■	■	TRIO (PO)
Other stainless steel	60	70	■	■	TRIO (PO)
Leaded brass	150	170	■	-	SOLO (DA)
Lead-free brass	150	170	■	■	SOLO (DA)
CuBe (copper alloys)	100	120	■	■	SOLO (DA)
Nickel silver (Maillechort)	120	140	■	■	SOLO (DA)
Bronze	120	140	■	■	SOLO (DA)
Aluminium	200	220	■	■	SOLO (DA)
Titanium	80	90	■	-	-

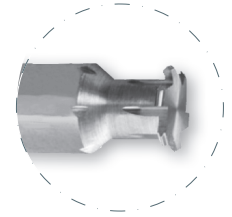
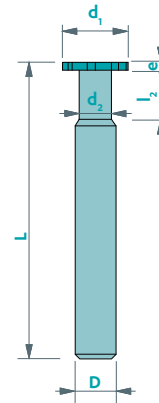

Tolerances D : h5

Standard modules: 0.030 - 1.000. Other modules upon request

d ₁	e	d ₂	l ₂	D	L	Z
<2	0.3 - 1.0	1.0	1	3	38	2 - 3
2	0.3 - 1.0	1.0	1	3	38	2 - 3
3	0.3 - 1.0	2.0	2	3	38	3
4	0.3 - 1.5	2.5	2	4	38	5
5	0.3 - 1.5	3.5	2	5	38	6
6	0.3 - 1.5	3.5	2	6	38	6
7	0.3 - 1.5	3.5	2	7	38	6
8	0.5 - 2.0	4.0	3	8	51	6
10	0.5 - 3.0	5.0	4	10	51	6
12	0.5 - 3.0	6.0	4	12	61	8
15	2.0 - 5.0	8.0	4	10	61	8
20	2.0 - 5.0	8.0	4	10	61	12
25	2.0 - 5.0	8.0	4	10	61	12

Option : circular saw

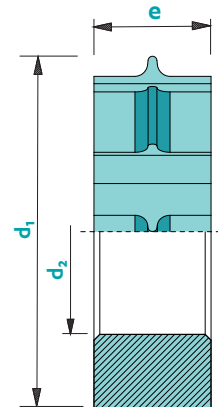

Available uncoated or coated



Z
2-12

CARB