

Form cutter with concave radius

Material	Vc uncoated	Vc coated	Uncoated	Coated	Rec. Coating*
Steel < 700 N/mm ²	100	130	□	■	Tisi (BQ)
Steel > 700 N/mm ²	80	100	-	■	Tisi (BQ)
Stainless steel	50	70	□	■	Tisi (BQ)
Cast iron	60	100	□	■	Tisi (BQ)
Copper	130	160	□	■	Solo (DA)
Brass - Bronze	140	190	■	□	Solo (DA)
Aluminium	200	350	□	■	Solo (DA)
Gold - Silver	140	180	■	■	Solo (DA)
Platinum - Palladium	-	35	-	□	Solo (DA)
Superalloys	-	40	-	■	Trio (PO)
Titanium	40	60	■	■	RICO (ZB)

not adapted - adapted □ highly adapted ■

Tolerances

d₁: e8
D: h5

⌀ +0.01/-0.01

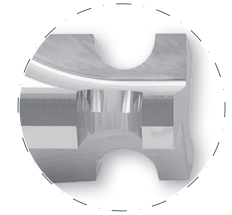
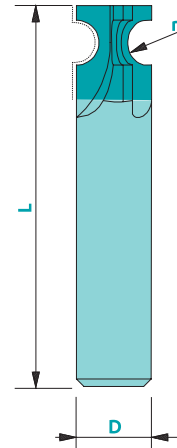

Art. n°	D	L	r*	Z		
					Uncoat.	Trio*
118-0d4.00r#.#Z#	4	38	0.50-0.75	3/4/5	▲	▲
118-0d6.00r#.#Z#	6	38	0.75-1.25	3/4/5	▲	▲
118-0d8.00r#.#Z#	8	51	1.00-2.00	3/4/5	▲	▲
118-0d10.00r#.#Z#	10	51	2.00-3.00	3/4/5	▲	▲
118-0d12.00r#.#Z#	12	51	2.50-3.50	3/4/5	▲	▲
118-0d14.00r#.#Z#	14	61	3.00-4.50	3/4/5	▲	▲

* r : available radius: every 0.05 mm

* Prices for other coatings: contact us!

To order a coated tool, add the 2-letter coating code to the article number

Available uncoated or coated (see page 308)



Z3-5



λ
0°

CARB

Order

Quotation request

<input type="checkbox"/> With exit angle 	Dimensions : D: _____ r: _____ L: _____ Z: _____	Coating : <input type="checkbox"/> Uncoated <input type="checkbox"/> Coated* : _____
	Machined material : _____	Cut: <input type="checkbox"/> right cut <input type="checkbox"/> left cut
<input type="checkbox"/> Without exit angle 	Order No : _____	Contact person : _____
Company's stamp & date : _____		

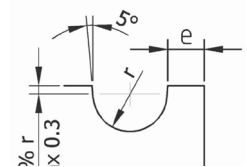

Standard dimensions of the bars : Ø 3x L 38, Ø 4x L 38, Ø 6x L 38, Ø 6x L 51, Ø 8x L 61, Ø 10x L 72, Ø 12x L 83, Ø 16x L 92, Ø 20x L 104

* Without information, the most suitable coating will be applied.